

SPACE UTILISATION

People Counting

A New Hope

Case Study

Bryce Hutchinson
Steve Ivanovski

BACKGROUND INFO - UTS

- ❖ Sydney - City Based Campus – Current 315,000 GFA
- ❖ 1 Billion Dollar Masterplan - Expanding GFA to 392,000 by 2015
- ❖ On Completion No Future Space Available For Expansion
- ❖ A Need to Drive Our Existing Spaces To Their Limits

UTS Space Management Team

- ❖ Manager – Space Management
- ❖ Facilities Information Manager
- ❖ Database Administrator



The Old Republic Way

Typical Space Utilisation Survey

(TEFMA Guidelines)

❖ Request For Survey	(Teaching & Learning)
❖ Funding Approval	(4 weeks)
❖ Return Brief	(2 weeks)
❖ Consultant Tender	(3 weeks)
❖ Tender Review & Approval Process	(2 weeks)
❖ Start Up Project	(4-6 weeks)
❖ Space Utilisation Survey	(1 week)
❖ Evaluate Data – Preliminary Report	(4-6 weeks)
❖ Client Feedback	(1 week)
❖ Final Report	(4 weeks)
❖ <u>Total</u>	<u>(29 weeks)</u>

Space Survey - How It Works

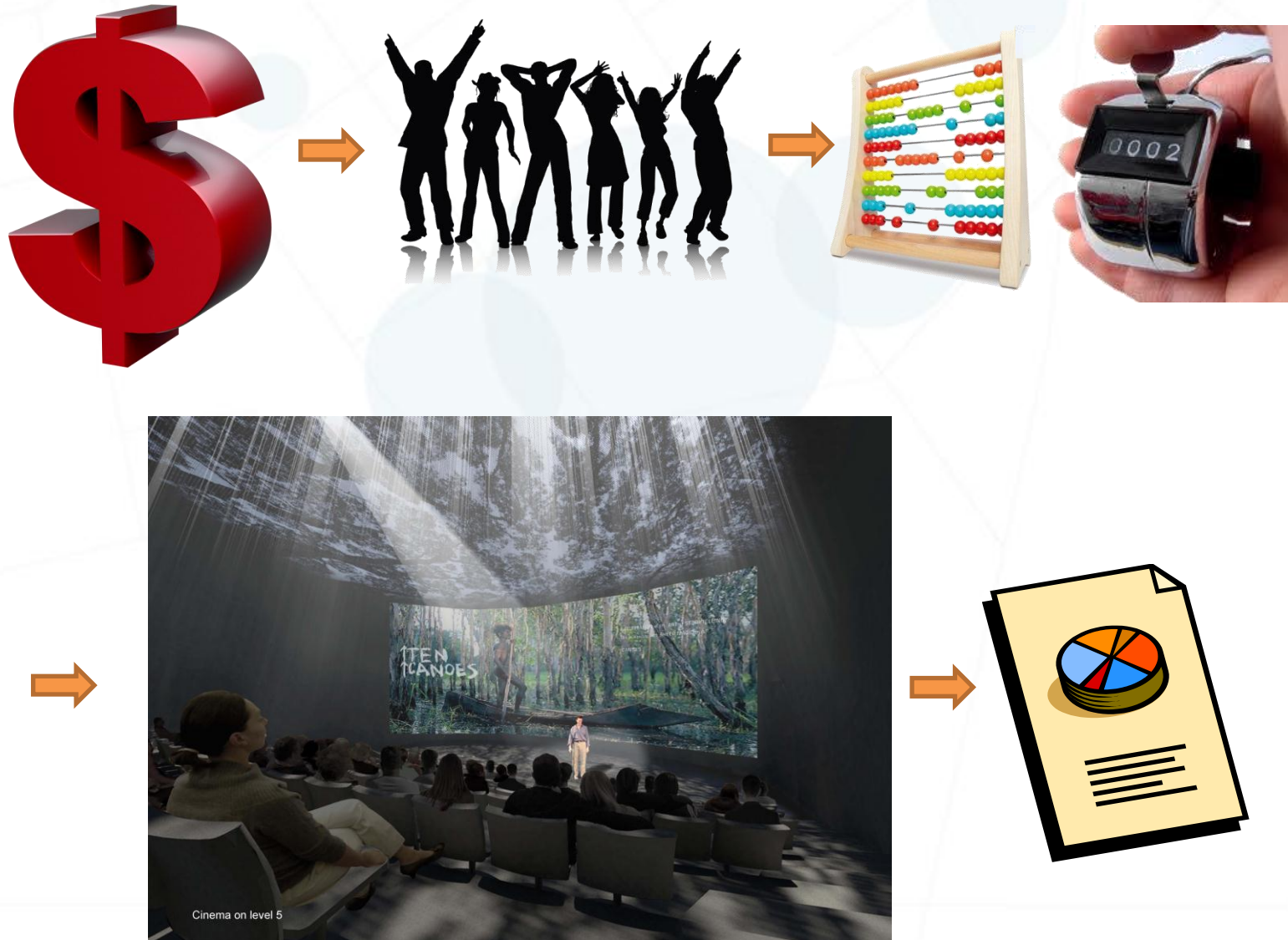

**MUST BE A
BETTER
SOLUTION**

? ? ?

The UTS Way

A New Hope

SASQUATCHPARK

Technologies Available For People Counting

- ❖ Camera
- ❖ Laser
- ❖ Thermal Image Sensors
- ❖ Lockable Spaces With Card Access
- ❖ Manual

Key Requirements

- ❖ Invisible – No Interruption to Classes
- ❖ Accurate
- ❖ 24/7 Live and Meaningful Data
- ❖ Syllabus Plus Interface (Time Tabling Software)
- ❖ Reporting – Daily/Weekly/Semester/Yearly
- ❖ Fully Automatic Reporting
- ❖ Cost Effective

Test Environment

Stage 1

- ❖ Thermal Image Sensor Technology
- ❖ 2 Units installed
- ❖ 1 General Teaching Space (GTS)
- ❖ 1 General Access Computer LAB
- ❖ Software Installation
- ❖ Reporting – Needs customisation to suit University Requirements

Test Environment

Stakeholders

- ❖ UTS – Special Reporting Requirements For Space Utilisation Surveys (TEFMA)
- ❖ Local Industry Partner

Test Environment

Stakeholders

- ❖ Issues
- ❖ Moving Forward !!
- ❖ **Alliance**
- ❖ Working Together To Help Achieve Our Goals



Test Environment

Stage 2

- ❖ 8 New Sensors
- ❖ Installed in 6 GTS Rooms
- ❖ On Going Reporting Development

❖ Stage 3

- ❖ Installation of 5 New Thermal Sensors in Informal Teaching & Learning Spaces (occupancy/traffic flows)
- ❖ New Report Interface

❖ Stage 4

- ❖ R&D Mechanical/Electrical Control Interface with Building Management System (BMS)

The New Hope

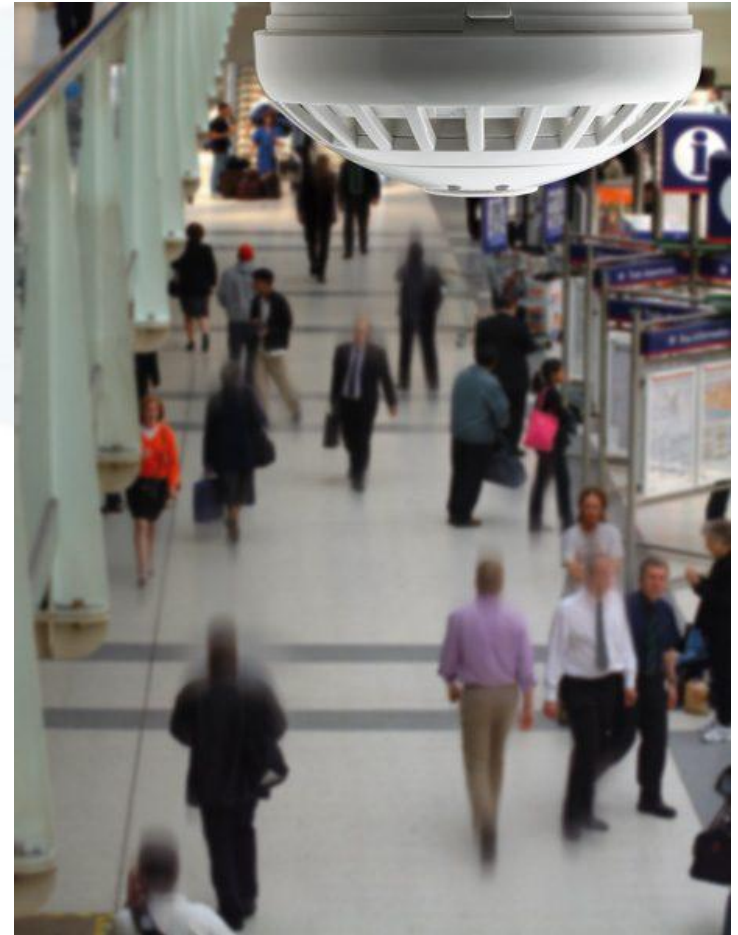

How It Works

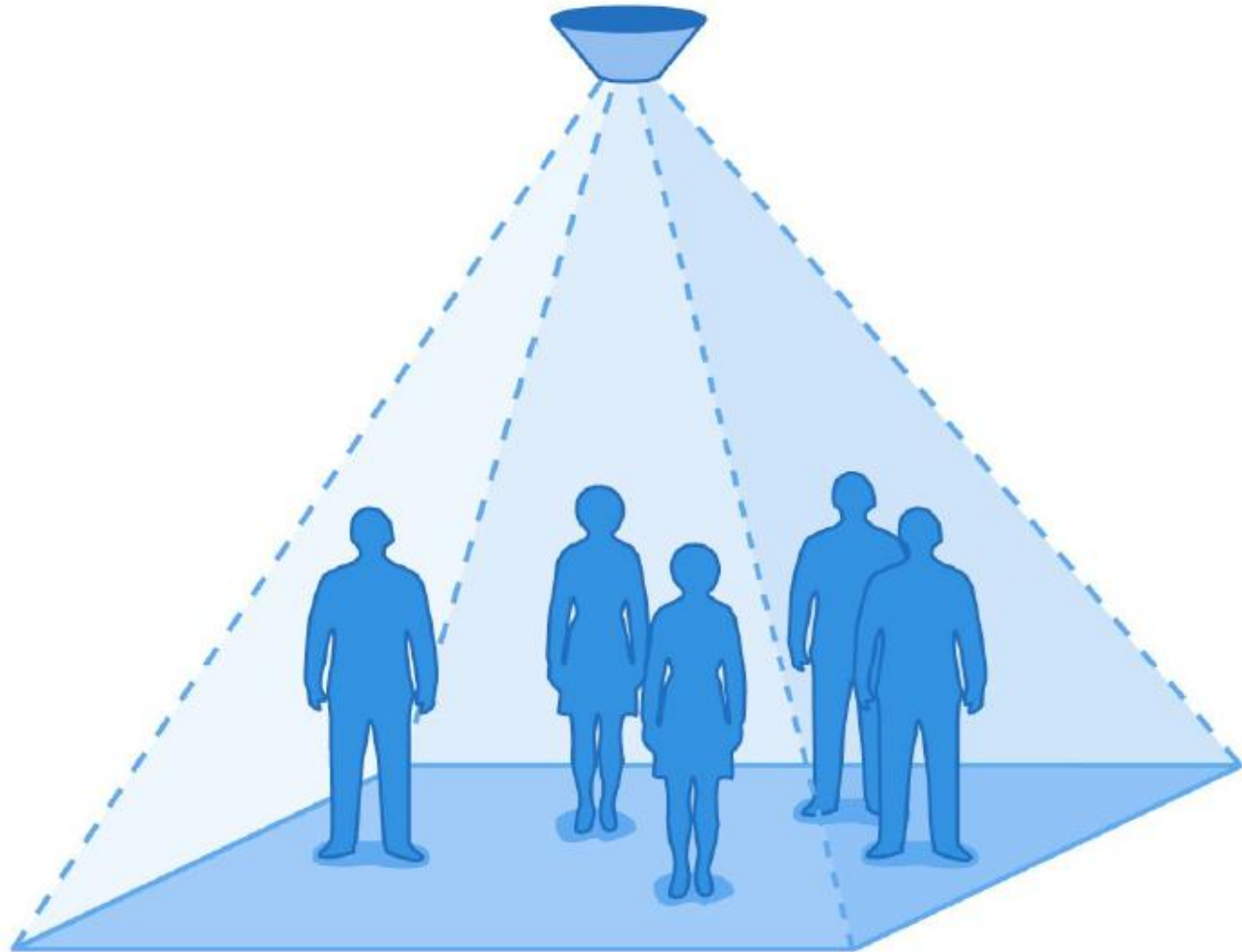

How It Works

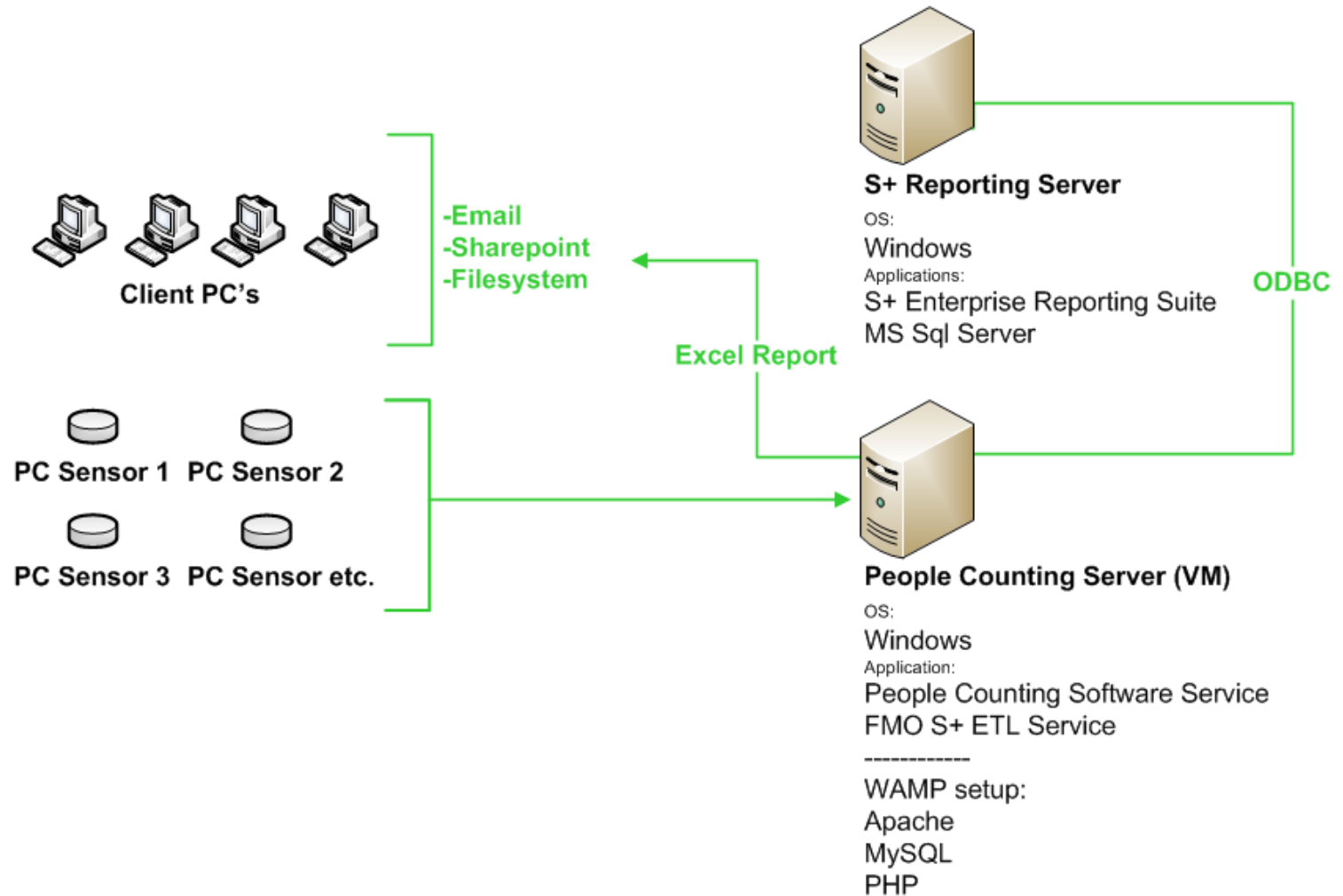

How It Works

- ❖ Server failsafe: sensors store 3 months worth of data in units, if server is offline sensors continually poll & collect data.
- ❖ Server can be a virtual machine
- ❖ Server uses a WAMP software stack, **W**indows, **A**pache, **M**ySQL, **P**HP.
- ❖ Units are powered via \geq Cat5 POE.

Sensor In Action

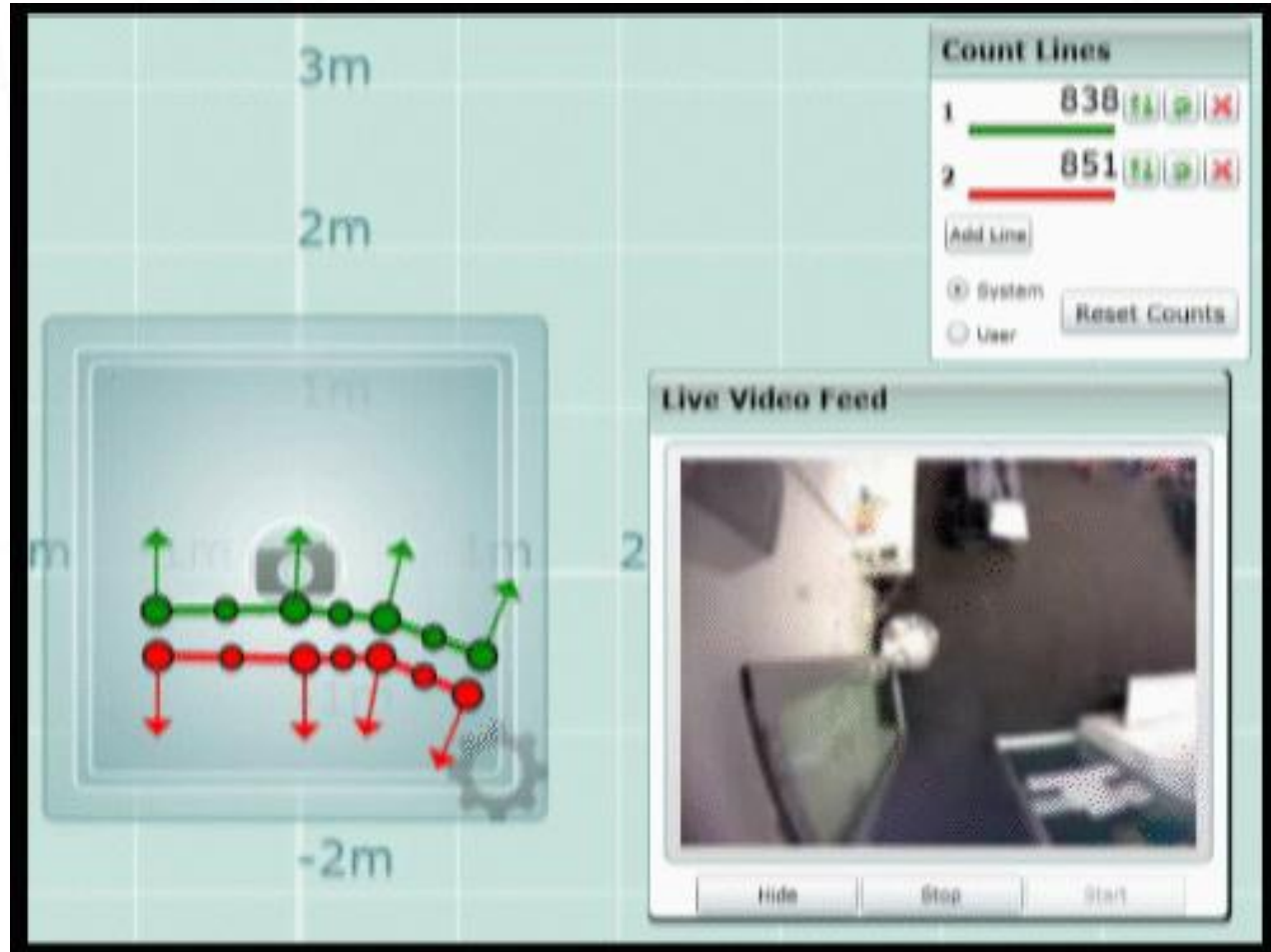

Reports

Space Usage Audit CB02.04.13 (Lecture Theatre, Capacity: 230)

Demo Site

Start of Audit 4/03/2013

End of Audit 10/03/2013

Peak Occupancy 199

	Core	Non-core	All	Target
Use	97/120	38/132	135/252	173/230
Freq	81%	29%	54%	75%
Occ	50%	16%	4%	75%
Util	40%	5%	2%	56%

Key

Unused in Core Periods
Unused in Non-Core Periods
No Show
Early Finish

Non-core
Used
Early Arrival/Overrun
Used without booking (Squat)
Low Occupancy in Core Periods

Day	C	NC	Date	Time	Cnt	Activity	Time	Cnt	Activity	Time	Cnt	Activity	Time	Cnt	Activity	Time	Cnt	Activity	Time	Cnt	Activity	Time	Cnt	Activity	Time	Cnt	Activity	Time	Cnt	Activity	Time	Cnt	Activity	Time	Cnt	Activity						
Monday			4-Mar	6:00	0		6:30	0		7:00	0		7:30	0		8:00	0		8:30	136	Lecture	9:00	136	Lecture	9:30	136	Lecture	10:00	0		10:30	24	Lecture	11:00	24	Lecture	11:30	24	Lecture			
Freq	20	1		6:30		Lecture	12:00	24	Lecture	12:30	24	Lecture	13:00	24	Lecture	13:30	161	Lecture	14:00	161	Lecture	14:30	161	Lecture	15:00	161	Lecture	15:30	0		16:00	0		16:30	137	Lecture	17:00	137	Lecture			
Occ	161	136		40%			18:00	67	Lecture	18:30	67	Lecture	19:00	67	Lecture	19:30	67	Lecture	20:00	0		20:30	0		21:00	0		21:30	0		22:00	0		22:30	0		23:00	0		23:30	0	
Util				33%		Core:	Unused	4	Periods	HasShw	0	Periods	Squat	0	Periods	Used	20	Periods	Total	1115		Non-Core	Unused	11	Periods	HasShw	0	Periods	Squat	0	Periods	Used	1	Periods	Total	138						
Tuesday			5-Mar	6:00	0		6:30	0		7:00	0		7:30	0		8:00	0		8:30	91	Lecture	9:00	91	Lecture	9:30	91	Lecture	10:00	91	Lecture	10:30	130	Lecture	11:00	130	Lecture	11:30	130	Lecture			
Freq	21	1		6:30		Lecture	12:00	107	Lecture	12:30	107	Lecture	13:00	107	Lecture	13:30	107	Lecture	14:00	162	Lecture	14:30	162	Lecture	15:00	162	Lecture	15:30	162	Lecture	16:00	62	Lecture	16:30	62	Lecture	17:00	62	Lecture			
Occ	162	91		41%		Lecture	18:00	53	Lecture	18:30	53	Lecture	19:00	53	Lecture	19:30	53	Lecture	20:00	0		20:30	0		21:00	0		21:30	0		22:00	0		22:30	0		23:00	0		23:30	0	
Util				36%		Core:	Unused	2	Periods	HasShw	1	Periods	Squat	0	Periods	Used	21	Periods	Total	1115		Non-Core	Unused	11	Periods	HasShw	0	Periods	Squat	0	Periods	Used	1	Periods	Total	91						
Wednesday			6-Mar	6:00	0		6:30	0		7:00	0		7:30	0		8:00	0		8:30	0		9:00	0		9:30	176	Lecture	10:00	176	Lecture	10:30	176	Lecture	11:00	176	Lecture	11:30	176	Lecture			
Freq	19	0		6:30		Squat	12:00	0		12:30	105	Lecture	13:00	105	Lecture	13:30	105	Lecture	14:00	0		14:30	126	Lecture	15:00	126	Lecture	15:30	126	Lecture	16:00	126	Lecture	16:30	126	Lecture	17:00	126	Lecture			
Occ	176	0		73%		Lecture	18:00	136	Lecture	18:30	136	Lecture	19:00	136	Lecture	19:30	136	Lecture	20:00	0		20:30	0		21:00	0		21:30	0		22:00	0		22:30	0		23:00	0		23:30	0	
Util				42%		Core:	Unused	4	Periods	HasShw	0	Periods	Squat	1	Periods	Used	19	Periods	Total	1115		Non-Core	Unused	12	Periods	HasShw	0	Periods	Squat	0	Periods	Used	0	Periods	Total	0						
Thursday			7-Mar	6:00	0		6:30	0		7:00	0		7:30	0		8:00	0		8:30	164	Lecture	9:00	164	Lecture	9:30	164	Lecture	10:00	164	Lecture	10:30	164	Lecture	11:00	0		11:30	164	Lecture			
Freq	19	1		6:30		Lecture	12:00	155	Lecture	12:30	155	Lecture	13:00	155	Lecture	13:30	155	Lecture	14:00	90	Lecture	14:30	90	Lecture	15:00	90	Lecture	15:30	90	Lecture	16:00	0		16:30	0		17:00	77	Lecture			
Occ	164	164		73%		Lecture	18:00	77	Lecture	18:30	77	Lecture	19:00	65	Lecture	19:30	65	Lecture	20:00	0		20:30	0		21:00	0		21:30	0		22:00	0		22:30	0		23:00	0		23:30	0	
Util				33%		Core:	Unused	3	Periods	HasShw	2	Periods	Squat	0	Periods	Used	19	Periods	Total	1115		Non-Core	Unused	11	Periods	HasShw	0	Periods	Squat	0	Periods	Used	1	Periods	Total	164						
Friday			8-Mar	6:00	0		6:30	0		7:00	0		7:30	0		8:00	0		8:30	0		9:00	116	Lecture	9:30	116	Lecture	10:00	116	Lecture	10:30	0		11:00	0		11:30	187	Lecture			
Freq	18	0		6:30		Lecture	12:00	187	Lecture	12:30	187	Lecture	13:00	187	Lecture	13:30	199	Lecture	14:00	199	Lecture	14:30	199	Lecture	15:00	199	Lecture	15:30	199	Lecture	16:00	154	Lecture	16:30	154	Lecture	17:00	154	Lecture			
Occ	199	0		67%		Lecture	18:00	123	Lecture	18:30	123	Lecture	19:00	0		19:30	0		20:00	0		20:30	0		21:00	0		21:30	0		22:00	0		22:30	0		23:00	0		23:30	0	
Util				50%		Core:	Unused	6	Periods	HasShw	0	Periods	Squat	0	Periods	Used	18	Periods	Total	1115		Non-Core	Unused	12	Periods	HasShw	0	Periods	Squat	0	Periods	Used	0	Periods	Total	0						
Saturday			9-Mar	6:00	0		6:30	0		7:00	0		7:30	0		8:00	6	External Hire	8:30	6	External Hire	9:00	6	External Hire	9:30	6	External Hire	10:00	6	External Hire	10:30	6	External Hire	11:00	6	External Hire	11:30	6	External Hire			
Freq	17			6:30		External Hire	12:00	6	External Hire	12:30	6	External Hire	13:00	6	External Hire	13:30	6	External Hire	14:00	6	External Hire	14:30	0		15:00	6	External Hire	15:30	6	External Hire	16:00	6	External Hire	16:30	6	External Hire	17:00	0	Early Finish			
Occ	6			6:30		External Hire	18:00	55	External Hire	18:30	55	External Hire	19:00	55	External Hire	19:30	0		20:00	0		20:30	0		21:00	0		21:30	0		22:00	0		22:30	0		23:00	0		23:30	0	
Sunday			10-Mar	6:00	0		6:30	0		7:00	0		7:30	0		8:00	55	External Hire	8:30	55	External Hire	9:00	55	External Hire	9:30	55	External Hire	10:00	55	External Hire	10:30	55	External Hire	11:00	55	External Hire	11:30	55	External Hire			
Freq	18			6:30		External Hire	12:00	55	External Hire	12:30	55	External Hire	13:00	0		13:30	0		14:00	0		14:30	0		15:00	0		15:30	55	External Hire	16:00	55	External Hire	16:30	55	External Hire	17:00	55	External Hire			
Occ	55			6:30		External Hire	18:00	55	External Hire	18:30	55	External Hire	19:00	55	External Hire	19:30	0		20:00	0		20:30	0		21:00	0		21:30	0		22:00	0		22:30	0		23:00	0		23:30	0	
Total	97	38		Capacity	230		Low Threshold (40% of capacity)	92		Total Occupancy of all used core periods										11046		Total Occupancy of all used non-core periods										1367		v3.1								

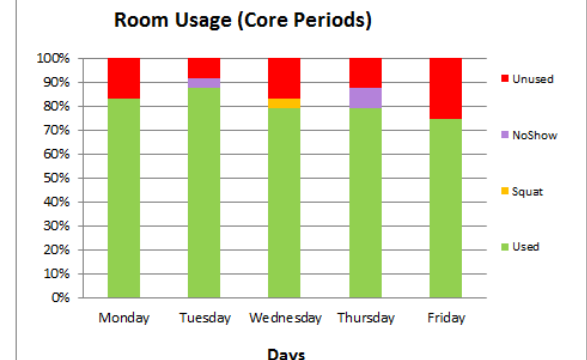
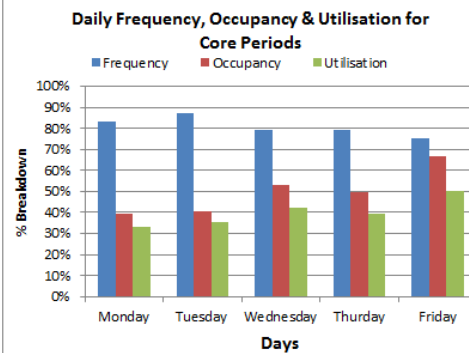
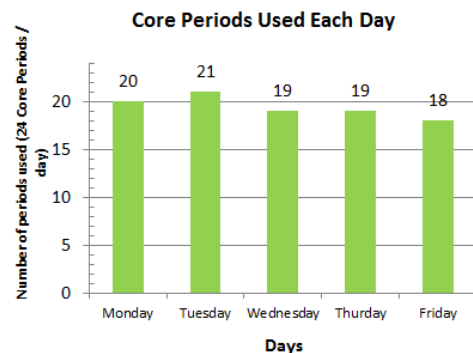

Reports



Space Usage Audit

No Shows and Early Finishes for the Year

University of Technology, Sydney



UNIVERSITY OF
TECHNOLOGY SYDNEY

Start of Year 1/01/2013

End of Year 31/12/2013

Prepared on 9/09/2013

Total hours booked but not used this year: No Shows: 1,961.5, Early Finish: 2,260.9 Total bookings not used this year: No Shows: 783, Early Finish: 846

No Shows / Early Finishes this year by Department (01/01/2013 to 31/12/2013) ignoring no-shows less than 30 mins

Department	Dept	Hours	Bookings	NS-Hours	NS-Bookings	EF-Hours	EF-Bookings
Marketing	AA	13	7	2	1	0	0
Building	AB	33.5	13	6.5	2	0	0
Law	AD	36	25	9	7	0	0
Audio Visual Services	AVS	51.5	9	17	3	0	0
Business	B	19.5	7	9	3	0	0
Law	BA	100.5	50	17	6	0	0
Management	BB	265	157	99	56	0	0
Medical and Molecular Biosciences	BE	25	13	2	1	0	0
Finance	BF	28	14	7	3	0	0
Marketing	BM	86	52	7	6	0	0
Careers	CAR	1	1	1	1	0	0
Engineering and Information Technology	D	190.5	58	72	12	0	0
Student Union	DC	227	93	63.5	27	0	0
Software	DE	885.00	380	200	88	0	0
Systems, Management and Leadership	DL	467.50	188	79.5	42	0	0
Electrical, Mechanical and Mechatronic System	DM	567.5	286	183	109	0	0
Software	DS	188	104	15	8	0	0
Facilities Hire	FAC	2,147.00	227	307.5	43	0	0
Facilities Management Unit	FMU	6.50	3	6.5	3	0	0
Arts and Social Sciences	G	113	47	14	7	0	0
Engineering and Information Technology	GC	246.5	123	38	19	0	0
Language Studies	GL	100	58	11	8	0	0
Social and Political Change	GP	321.5	178	68	38	0	0
Cultural Studies	GS	117.5	63	11	7	0	0
Student Union	INT	49.5	28	20.5	12	0	0
Health	J	175	90	56.5	33	0	0
Mathematical Sciences	L	162	75	25	13	0	0
Marketing & Communications Unit	MCU	221.5	21	67.5	10	0	0
Science	N	55.5	22	19.5	7	0	0
Environmental Sciences	NE	90	44	35	12	0	0
Medical and Molecular Biosciences	NH	482	194	125.5	43	0	0
Mathematical Sciences	NM	460.00	260	130	71	0	0
Law	NP	134	61	72	36	0	0
Institute for Interactive Media and Learning	PC	122	35	62.5	16	0	0
Student Administration Unit	SAU	1,812.00	104	1	1	0	0
Student Services Unit	SSU	377	55	10.5	6	0	0
Student Association	STA	18	2	9	1	0	0
Student Union	UNI	135.5	27	68.5	14	0	0

Reports



Space Usage Audit

No Shows and Early Finishes for the Term

University of Technology, Sydney



UNIVERSITY OF
TECHNOLOGY SYDNEY

Start of Term 29/07/2013

End of Term 8/11/2013

Prepared on 0/01/1900

Total hours booked but not used this term: No Shows: 225.0, Early Finish: 369.4 Total bookings not used this term: No Shows: 90, Early Finish: 210

No Shows / Early Finishes this term (Spring) showing individual bookings (29/07/2013 to 08/11/2013) ignoring no-shows less than 30 mins

Dept	Title	Session	Room	Start	Hours	NS-Hours	EF-Hours
FAC	Church Group _Facilities Hire (Michelle x4011	~0000\$ _EN0000_train_B	CB02.04.29	17/08/2013 6:00	16	16	0
MCU	Open day _Anna Yiasemides x1697	~MCU_Open day_31Aug	CB02.04.29	31/08/2013 6:00	18	0	15.9
MCU	Open day _Anna Yiasemides x1697	~MCU_Open day_31Aug	CB02.04.13	31/08/2013 6:00	18	0	15.2
MCU	Open day _Anna Yiasemides x1697	~MCU_Open day_31Aug	CB02.04.11	31/08/2013 6:00	18	0	14.2
MCU	Open day _Anna Yiasemides x1697	~MCU_Open day_31Aug	CB02.04.23	31/08/2013 6:00	18	0	14
FAC	Indonesian Reform _Facilities Hire (Michelle	~448\$ _EN8599_reli_B	CB02.05.31	11/08/2013 8:00	12	12	0
FAC	Indonesian Reform _Facilities Hire (Michelle	~448\$ _EN8599_reli_B	CB02.05.32	11/08/2013 8:00	12	12	0
FAC	Indonesian Reform _Facilities Hire (Michelle	~448\$ _EN8600_reli_A	CB02.04.13	8/09/2013 8:00	12	0	11.6
FAC	Indonesian Reform _Facilities Hire (Michelle	~448\$ _EN8600_reli_B	CB02.05.31	8/09/2013 8:00	12	0	11.1
FAC	Indonesian Reform _Facilities Hire (Michelle	~448\$ _EN8600_reli_B	CB02.05.32	8/09/2013 8:00	12	0	10.9
FAC	IELTS _Facilities Hire (Rachael x4684)	~165\$ _EN8677_exam_A	CB02.07.4B	3/08/2013 8:00	10	0	9.6
FAC	IELTS _Facilities Hire (Rachael x4684)	~165\$ _EN8678_exam_A	CB02.04.13	7/09/2013 8:00	10	0	9.6
FAC	IELTS _Facilities Hire (Rachael x4684)	~165\$ _EN8677_exam_B	CB02.04.13	17/08/2013 8:00	10	0	9.5
FAC	IELTS _Facilities Hire (Rachael x4684)	~165\$ _EN8677_exam_A	CB02.04.13	3/08/2013 8:00	10	0	9.5
FAC	IELTS _Facilities Hire (Rachael x4684)	~165\$ _EN8677_exam_B	CB02.07.4B	17/08/2013 8:00	10	0	9.4
FAC	IELTS _Facilities Hire (Rachael x4684)	~165\$ _EN8677_exam_A	CB02.05.32	3/08/2013 8:00	10	0	9.3
FAC	IELTS _Facilities Hire (Rachael x4684)	~165\$ _EN8678_exam_A	CB02.07.4B	7/09/2013 8:00	10	0	9.3
FAC	Indonesian Reform _Facilities Hire (Michelle	~448\$ _EN8599_reli_B	CB02.05.32	25/08/2013 8:00	12	0	9.2
STA	Solidarity Club _Weekend long meeting _JEAN PA	~STA_Solidarity_17Aug	CB02.04.11	17/08/2013 9:00	9	9	0
FAC	Church Group _Facilities Hire (Michelle x4011	~0000\$ _EN0000_train_B	CB02.04.29	18/08/2013 6:00	16	0	8.9
FAC	Indonesian Reform _Facilities Hire (Michelle	~448\$ _EN8600_reli_C	CB02.04.11	1/09/2013 8:00	12	0	8.7
FAC	Indonesian Reform _Facilities Hire (Michelle	~448\$ _EN8600_reli_B	CB02.05.31	1/09/2013 8:00	12	0	8.5
FAC	Indonesian Reform _Facilities Hire (Michelle	~448\$ _EN8599_reli_C	CB02.04.11	4/08/2013 8:00	12	0	8.2
FAC	Indonesian Reform _Facilities Hire (Michelle	~448\$ _EN8599_reli_B	CB02.05.31	25/08/2013 8:00	12	0	8.1
FAC	Indonesian Reform _Facilities Hire (Michelle	~448\$ _EN8599_reli_B	CB02.05.32	4/08/2013 8:00	12	0	8.1
FAC	Indonesian Reform _Facilities Hire (Michelle	~448\$ _EN8599_reli_B	CB02.05.31	4/08/2013 8:00	12	0	7.1
J	Issues in Australian Health Services (Worksho	92606_SPR_U_1_B_Wks2/01	CB02.04.11	31/07/2013 9:00	8	0	6.3

NoShows and Early Finishes for Spring Term

Page 1 of 20

Reports

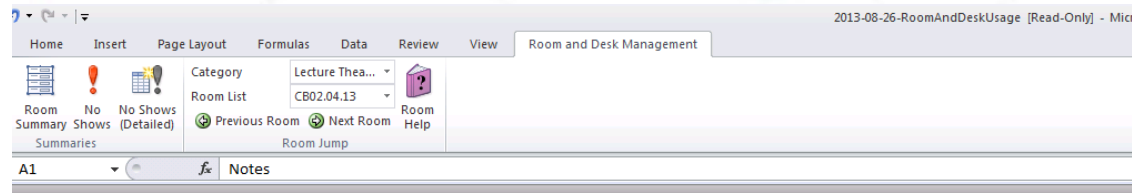

Click to add header

Notes

The reports are based on the AAPPA Space Planning Guidelines, which can be downloaded from [www.tefma.com](http://www.tefma.com/www.tefma.com/uploads/content/26-SpaceGuidelines.pdf)

Use

Use is divided into Core, Non-core and Total. The figure before the '/' is the number of periods used, and the figure after is the number of periods available. Core periods are 9am-9pm (12 hours) Monday to Friday. Non-core periods are 6am-9am and 9pm to midnight weekdays, and 6am-midnight at weekends

Frequency

Room Frequency is the number of hours the room is in use, during the audit period, divided by the number of hours that the room is available for use, during the audited period.

Frequency = PeriodsUsed / PeriodsAvailable

PeriodsUsed = the number of periods the room was in use during the audit period.

PeriodsAvailable = the maximum number of periods the room could be used during the audit period.

Room Frequency pertains to the room being physically in use, not the theoretical use as recorded as bookings on a room booking or scheduling system.

Occupancy

Room Occupancy represents the average number of students in the room, when the room is in use, compared to the total room capacity. Room Occupancy is independent of Room Frequency.

Occupancy = TotalStudentPeriods / (Capacity x PeriodsUsed)

TotalStudentsPeriods = Total number of students counted in the room over the audit period.

Capacity = the maximum number of students the room can hold, usually based on the number of seats in the room.

PeriodsUsed = the number of periods the room was in use during the audit period. As Room Occupancy is dependent on the accuracy of Capacity, and Capacity is generally an approximate measure (particularly in spaces other than classrooms and lecture theatres), Room Occupancy data can be misleading. Room Occupancy levels above 100% can occur.

A Room Occupancy level in excess of 100% may be due to either overcrowding or reflect how the facility is being used, e.g. a laboratory space may be used as a convenient seminar space between laboratory classes. The number of students may exceed the room's listed capacity as a laboratory. Another concern with Room Occupancy data is the difference between students enrolled in a course, and the number of students attending the classes. Rooms must be booked to allow for every enrolled student to attend the class, even if this rarely occurs. In these cases low occupancy may not be an issue with the facilities provided.

Utilisation

Utilisation = Frequency x Occupancy

Utilisation combines Room Occupancy and Room Frequency data to give an indication of how the room is being used. Utilisation, as an abstract measure, is only useful as an indicator of rooms requiring further investigation of usage patterns, and comparative assessments.

Abbreviations

WRB-Active = Web Room Booking

Squat = Room Used without Booking

No Show = Room booked but not used

Check Data

Why do I sometimes see the link, 'Check Data' on the summary sheet?

If you see this, it means that there is a problem with the data integrity, possibly caused by a problem with the SQL queries. If you follow the link, it will take you to the sheet where the data integrity is checked, and it should be clear what is wrong.



The UTS Way

Moving Forward : Further R&D

BMS / HVAC Control

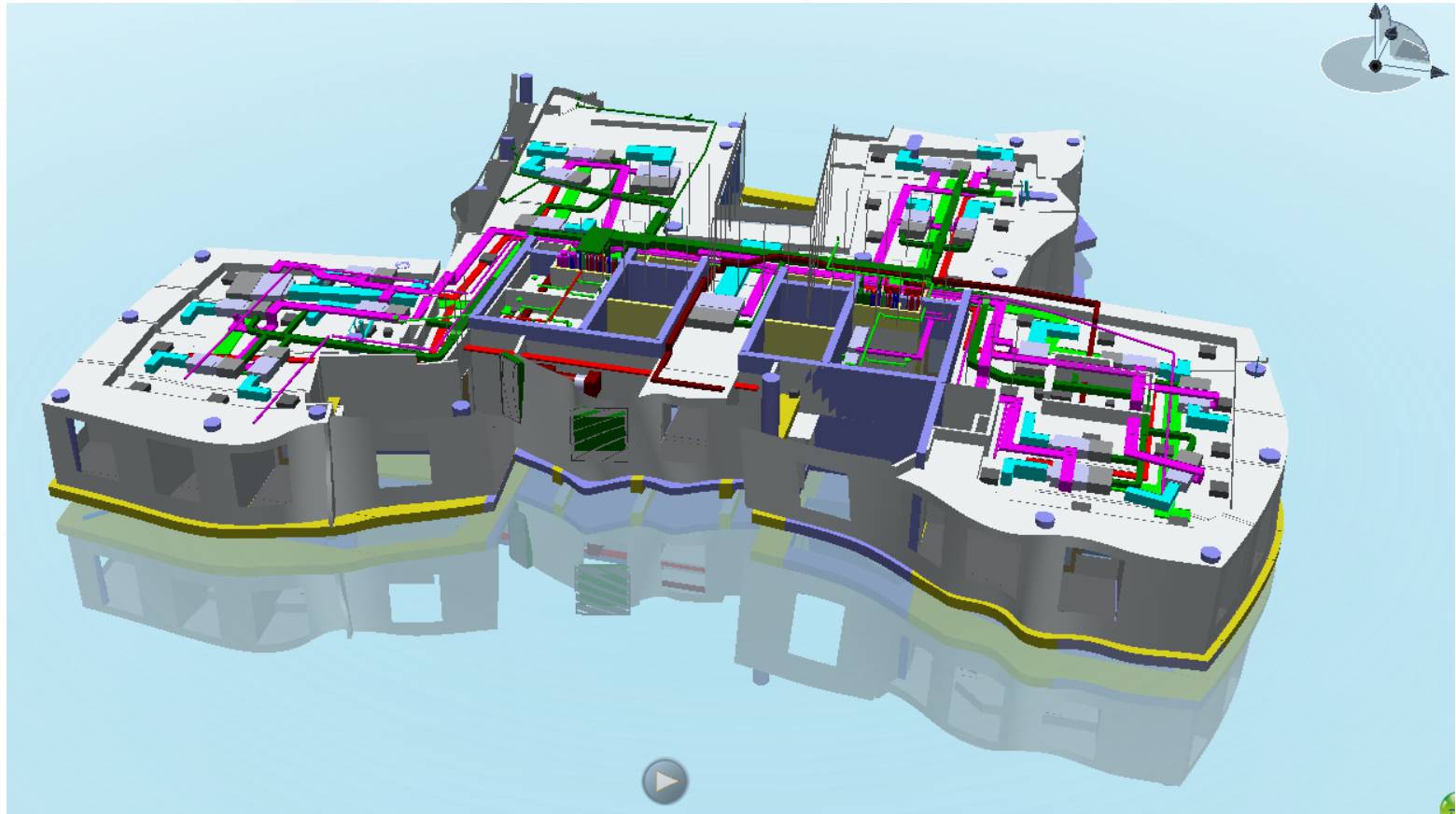

CB08 - Dr Chau Chak Wing Building (GHery)

BMS / HVAC Control

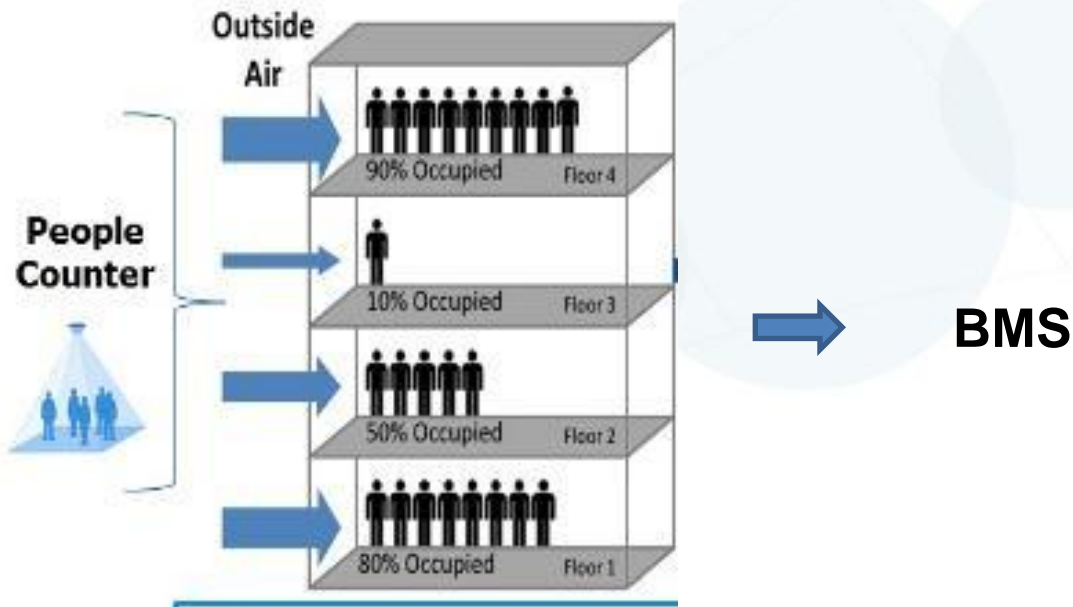

Archibus Interface

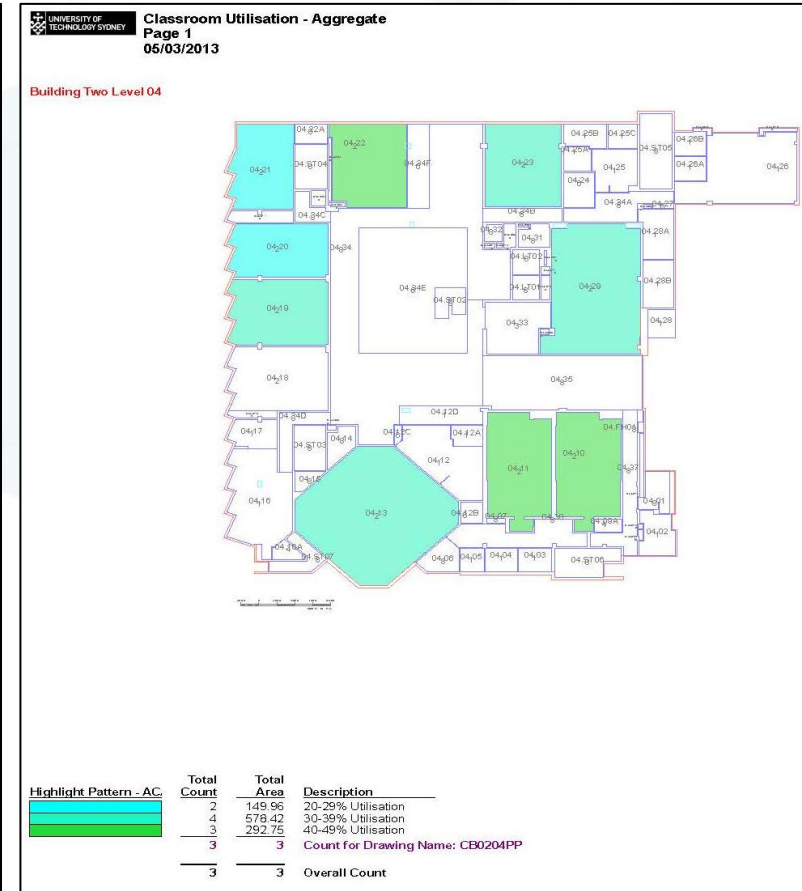
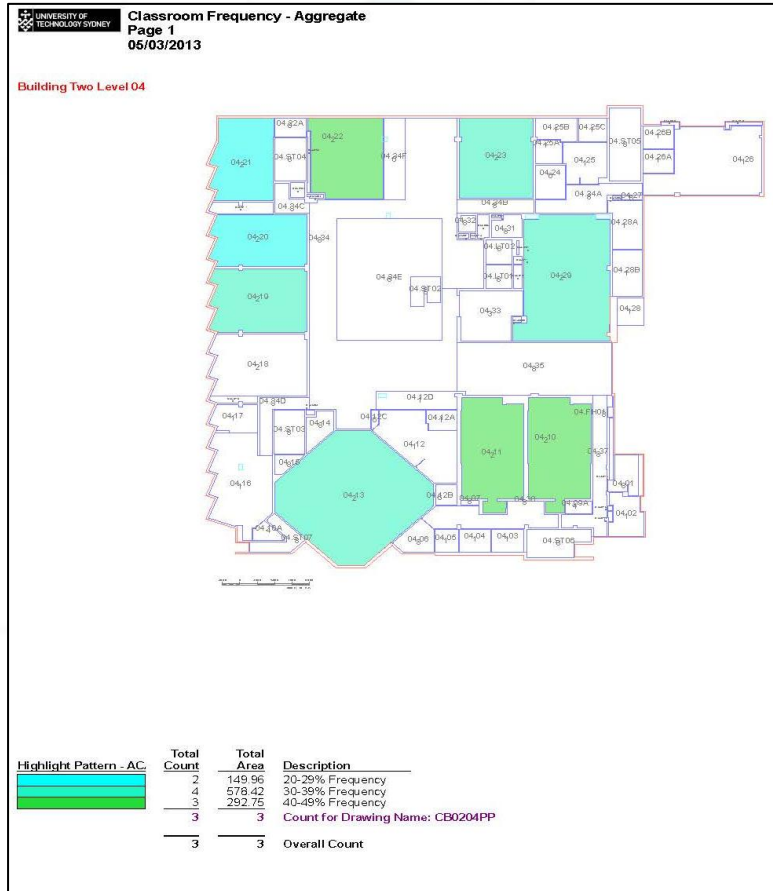

Email Notification

- ❖ Client Feedback:
 - ✓ No Show
 - ✓ Early Finish
 - ✓ Poor Occupancy
- ❖ Security
 - ✓ Room Alert Out Of Hours Usage

Benefits

- ❖ Real Time Data
- ❖ Meaningful and Accurate Space Utilisation Reports
- ❖ Highlight No Shows, Early Finishes, Utilisation
- ❖ User Feedback
- ❖ Reports on Frequency, Occupancy and Utilisation to TEFMA Standards
- ❖ Demonstrate Efficiency Gains For Government Reporting
- ❖ Energy Reduction



Accelerating Ahead

Questions??



Thank You

Contact Details:
Bryce.Hutchinson@uts.edu.au

